

#### DIMENSIONAL NOTES:

DRAWING REFLECTS KLCE, KHL, KSHL AND KSLL TYPE CONTROLLERS. FOR DETAILED DIMENSIONS OF THESE AND OTHER CONTROLLERS AND SWITCHES, REFER TO OUTLINE DRAWING FOR SPECIFIC UNIT DESIRED.

#### PARTS SUPPLIED BUT NOT SHOWN:

- (1) DOOR SEAL
- (2) DOOR MOUNTING BOLTS
- (2) DOOR MOUNTING BOLT SEALS
- (2) DOOR MOUNTING BOLT WASHERS
- (2) DOOR MOUNTING BOLT NUTS

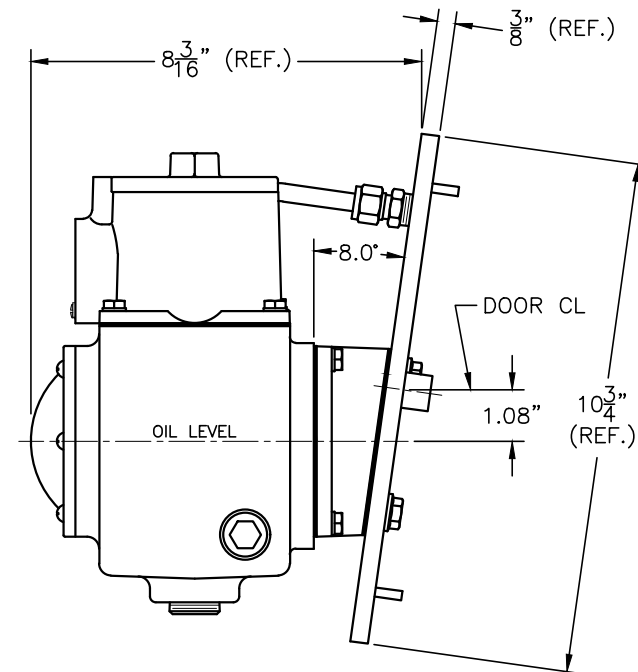

FOR WAUKESHA VHP P9394GSI ENGINE  
WITH OPTIONAL SHALLOW OIL PAN  
REPLACES INSPECTION DOOR  
WITH TWO MOUNTING HOLES

DIMENSIONS ARE FOR REFERENCE  
PURPOSES ONLY AND ARE SUBJECT TO  
CHANGE AT ANY TIME WITHOUT NOTICE.

INFORMATION IS PROPRIETARY TO KENCO ENGINEERING CO.

REV.	DATE	BY	CHKD.	ECN	EXPLANATION:	KENCO ENGINEERING COMPANY TULSA, OKLAHOMA		
A	04-25-25	RDM	DM	N/A	MODEL KLCE-28S WAS MODEL NO. 85474; P9394GSI ENGINE WITH SHALLOW OIL PAN WAS P9394GSI ENGINE; ITEM 2 P/N WAS 85474-1; ITEM 4 P/N WAS 33927	CONTROLLER, OIL LEVEL MODEL KLCE TYPE WITH TYPE 28S ADAPTER		
						DATE: 05-15-20	SHEET: 1 OF 2	DRAWING NUMBER
						DRN. BY: RDM	CHKD. BY: KLM	85474
						SCALE: NONE	REVISION: A	