

**DIMENSIONAL NOTES:**  
DRAWING REFLECTS KLCE, KHL, KSHL AND KSLL TYPE CONTROLLERS. FOR DETAILED DIMENSIONS OF THESE AND OTHER CONTROLLERS AND SWITCHES, REFER TO OUTLINE DRAWING FOR SPECIFIC UNIT DESIRED.

- PARTS SUPPLIED BUT NOT SHOWN:**
- (1) 50-KFS FIRE SAFE VALVE (NOTE: NOT SUPPLIED IF ORDERED WITH "FSN50" OPTION)
  - (1) DOOR SEAL
  - (2) DOOR MOUNTING BOLTS
  - (2) DOOR MOUNTING BOLT SEALS
  - (2) DOOR MOUNTING BOLT WASHERS
  - (2) DOOR MOUNTING BOLT NUTS

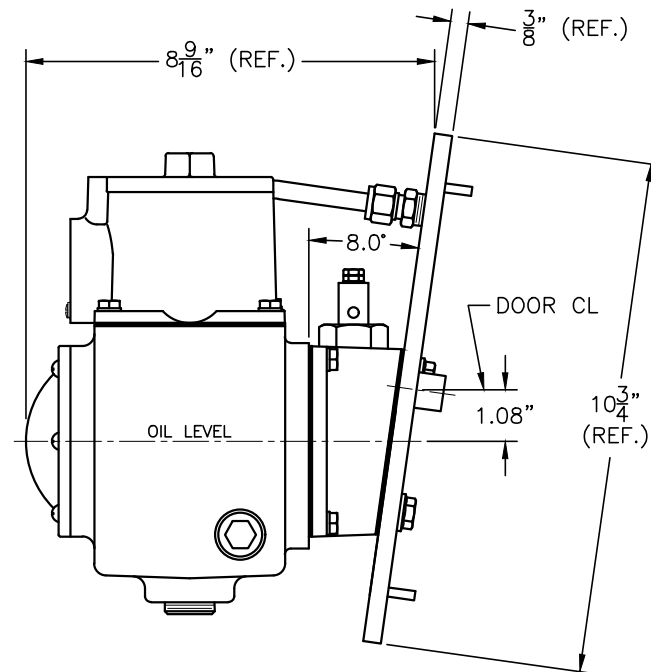

**FOR WAUKESHA VHP P9394GSI ENGINE  
WITH OPTIONAL SHALLOW OIL PAN  
REPLACES INSPECTION DOOR  
WITH TWO MOUNTING HOLES**

DIMENSIONS ARE FOR REFERENCE PURPOSES ONLY AND ARE SUBJECT TO CHANGE AT ANY TIME WITHOUT NOTICE.

INFORMATION IS PROPRIETARY TO KENCO ENGINEERING CO.

REV.	DATE	BY	CHKD.	ECN	EXPLANATION:	KENCO ENGINEERING COMPANY TULSA, OKLAHOMA		
A	04-28-25	RDM	DM	N/A	MODEL KLCE-28S-FS WAS MODEL NO. 85475 AND MODEL KLCE-28S-FSN50 WAS 85475-FSN50; P9394GSI ENGINE WITH SHALLOW OIL PAN WAS P9394GSI ENGINE; ITEM 2 P/N WAS 85475-1; ITEM 4 P/N WAS 33927	CONTROLLER, OIL LEVEL MODEL KLCE TYPE WITH TYPE 28S-FS ADAPTER		
						DATE: 05-14-20	SHEET: 1 OF 2	DRAWING NUMBER
						DRN. BY: RDM	CHKD. BY: KLM	85475
						SCALE: NONE	REVISION: A	