

RELIEF PRESSURE ADJUSTMENT RANGE: 0 TO 150 PSI
RELIEF PRESSURE FACTORY SETTING: 50 PSI

WETTED MATERIALS:

BODY: PVC
DIAPHRAGM: TEFLON (WETTED)/EPDM (NON-WETTED)

NON-WETTED MATERIALS:

SPRING CASE: PVC
RELIEF PRESSURE ADJUSTING SCREW: PVC
SPRING: ZINC PLATED SPRING STEEL
NUTS, BOLTS & WASHERS: 18-8 STAINLESS STEEL

MODEL NUMBER:

KPRV-T-75-P-P-TE (THREADED CONNECTIONS)
KPRV-S-75-P-P-TE (SOCKET WELD CONNECTIONS)

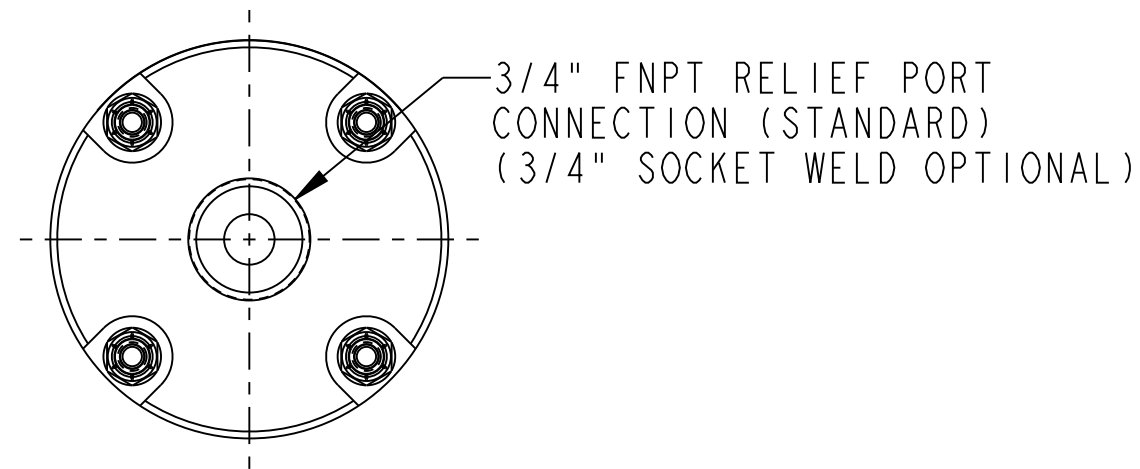

B	5/20/15	LR	REVISED TO SHOW CHANGE TO LABEL	DIM'S IN INCHES TOLERANCES UNLESS OTHERWISE SPECIFIED.	 Tulsa, Oklahoma USA	MATERIAL:	SEE B/M		
	N/A	BRC				RELEASE LEVEL:	RELEASED		
A	5/06/15	BRC	RELEASED	 ANGULAR ±1/2° FRACTIONAL ±1/64" (X.X) ±0.015" (X.XX) ±0.010" (X.XXX) ±0.005" MACH FILLET RAD: .031" 125 MAX. FINISH, ALL MACHINED SURFACES. 	DRAWING CREATED IN PRO/ENGINEER	TITLE:			
	N/A	KLM				VALVE, KPRV RELIEF, 3/4", BOLTED			
REV.	DATE	DRN.	DESCRIPTION	 MACH FILLET RAD: .031" 125 MAX. FINISH, ALL MACHINED SURFACES. 	DRN. BY:	BRC	SCALE:	0.600	DRAWING NUMBER
	ECN	CHKD.			CHKD. BY:	KLM	REVISION:	B	
PROPRIETARY: THIS DRAWING AND THE INFORMATION CONTAINED HEREIN IS PROPRIETARY TO KENCO ENGINEERING CO. AND SHALL NOT BE REPRODUCED, COPIED, OR DISCLOSED IN WHOLE OR IN PART, OR USED FOR MANUFACTURE OR FOR ANY OTHER PURPOSE WITHOUT THE WRITTEN PERMISSION OF KENCO ENGINEERING.				DATE:	5/06/15	SHEET 1 OF 3		73455	