

**OPERATING PRINCIPLE**

A typical Fire Safe Oil Control System has two spring-loaded, thermally actuated Kenco Fire Safe valves. In the event of a fire, the valve's eutectic fuse element melts and the valves close automatically. This prevents the oil contained inside the crankcase and the oil reserve tank from feeding the fire.

**BENEFITS:**

- Lower insurance rates
- Protection in case of fire to equipment
- Protection of personnel
- Protection of environment
- Prevents oil supply from feeding a fire

**SPECIFICATIONS**

- Valve Body: Zinc Plated Carbon Steel (316 S.S. optional)
- Spring: Stainless Steel (Inconel on 10-KFS, 125-KFS, 15-KFS and 20-KFS)
- Valve Plunger: Carbon Steel (316 S.S. optional)
- Seal Material: Fluorocarbon
- Thermal Fuse Melting Temp.: 360°F
- Maximum Working Pressure: 70 psig
- Connection Sizes: 1/2" FNPT, 3/4" FNPT, 1" FNPT, 1-1/4" FNPT, 1-1/2" FNPT and 2" FNPT

**TYPICAL INSTALLATION**

**INLET SIDE:**

Install the Model 50-KFS as close to the controller inlet (or Kenco Low Flow Meter) as possible.

**OUTLET SIDE:**

Install the Model 75-KFS as close to the engine crankcase as possible.

\*Note: Flow through valve is bidirectional.

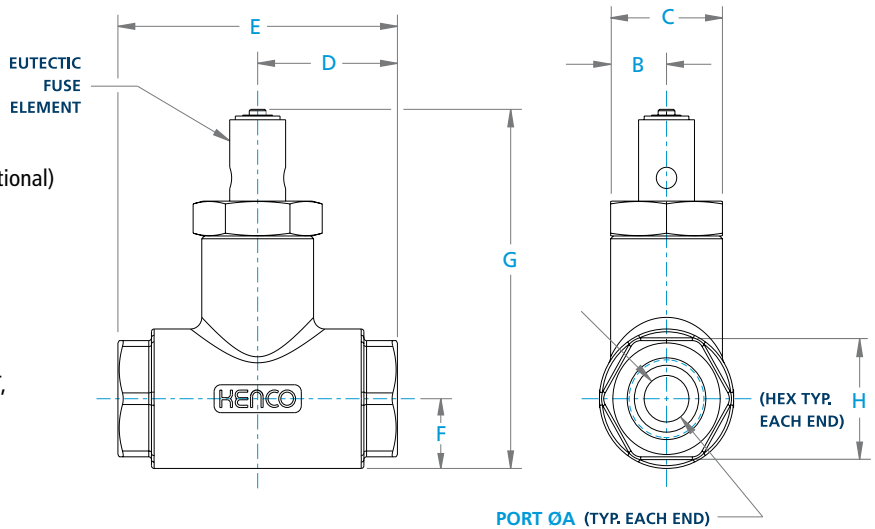

**Dimensional Information**

Valve Model	50-KFS	75-KFS	10-KFS	125-KFS	15-KFS	20-KFS
Connection Size	1/2" FNPT	3/4" FNPT	1" FNPT	1-1/4" FNPT	1-1/2" FNPT	2" FNPT
A	1 1/2"	3/4"	1"	1-1/2"	1-1/2"	2"
B	5/8"	3/4"	15/16"	1-1/8"	1-1/8"	1-5/8"
C	1-1/4"	1-1/2"	1-7/8"	2-1/4"	2-1/4"	3-1/4"
D	1-9/16"	1-3/4"	2-1/16"	2-9/16"	2-9/16"	3-7/16"
E	3-1/8"	3-1/2"	4-1/8"	5-1/8"	5-1/8"	6-7/8"
F	3/4"	7/8"	1-1/32"	1-7/16"	1-7/16"	1-7/8"
G (C.S.)	3-7/8"	4-3/8"				
G (S.S.)	4-1/8"	4-5/8"	5-7/32"	7-1/8"	7-1/8"	9-7/16"
H	1-5/16"	1-9/16"	1-3/4"	2-1/2"	2-1/2"	3-5/16"

Note: The model designations shown in the table above represent the order number for standard Carbon Steel Fire Safe valves. To order Stainless Steel Fire Safe valves, add the suffix "-SS" to the end of the order number. (Example: A 1/2" NPT Stainless Steel Model 50-KFS Fire Safe valve would be ordered as 50-KFS-SS)

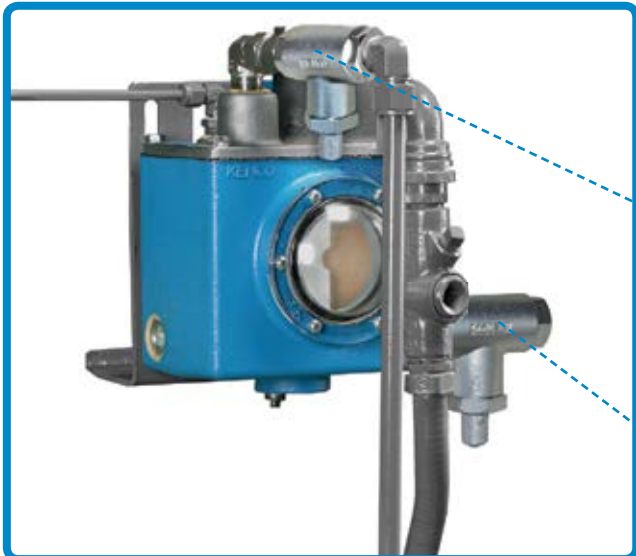

**INLET SIDE:**

In case of a fire, stops oil from flowing from oil reserve supply.



**OUTLET SIDE:**

In case of a fire, stops back flow of oil from crank case.