

44M25-B / 44M50-B WETTED MATERIALS:
 BRASS, 316 STAINLESS STEEL, GLASS AND AFLAS,
 BUNA, ETHYLENE PROPYLENE, FLUOROCARBON OR
 KALREZ O-RING SEALS

44M25-S / 44M50-S WETTED MATERIALS:
 316 STAINLESS STEEL, GLASS AND AFLAS, BUNA,
 ETHYLENE PROPYLENE FLUOROCARBON OR KALREZ
 O-RING SEALS

DIMENSIONAL NOTE:
 ALL DIMENSIONS ARE FOR REFERENCE PURPOSES
 ONLY AND ARE SUBJECT TO CHANGE AT ANY TIME
 WITHOUT NOTICE.

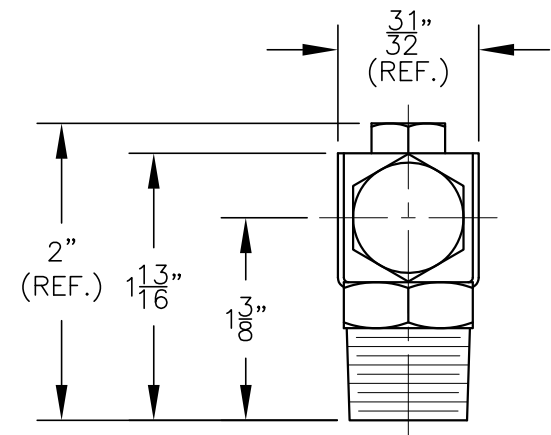
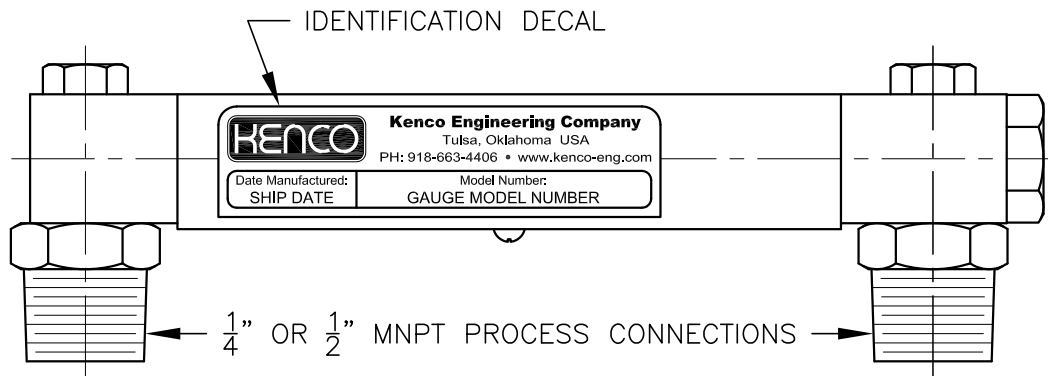

NOTE: REFER TO 85181 FOR INSTALLATION INSTRUCTIONS AND SPARE PARTS

INFORMATION IS PROPRIETARY TO KENCO ENGINEERING CO.

REV.	DATE	BY	CHKD.	ECN	EXPLANATION:
G	04-16-15	RDM	KLM	N/A	ITEM 10 P/N ON "-B" AND "-S" GAUGES WAS 29531-S6; ITEM 10 P/N ON "-C" GAUGE WAS 29531-CS
H	04-16-20	RDM	KLM	N/A	ADDED SHEET 1; REMOVED ALUMINUM AND CARBON STEEL MATERIAL OPTIONS

KENCO ENGINEERING COMPANY
 TULSA, OKLAHOMA

GAUGE, BULK TANK (4400 SERIES)

DATE: 02-11-97	SHEET: 1 OF 2	DRAWING NUMBER
DRN. BY: RDM	CHKD. BY: DM	A-29565
SCALE: $3/4$ "=1"	REVISION: H	A-29566